

*FICHA TÉCNICA*

**PASADOR ISO 8745**

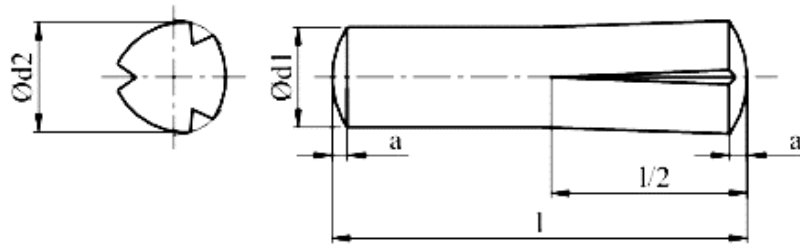

**DIMENSIONES**

$d_1$	nom.	1,5	2	2,5	3	4	5	6	8	10	12	16	20	25		
	tol.	h9				h11										
$a$	$\approx$	0,2	0,25	0,3	0,4	0,5	0,63	0,8	1	1,2	1,6	2	2,5	3		
$l$		<i><math>d_2</math> expanded diameter</i>														
8	1,63	2,15	2,65	3,2	3,25	4,25	5,25	6,25	8,25	10,3	12,3	16,5	20,55	25,5		
10																
12																
14																
16																
18																
20	2,7	3,3	4,3	5,3	6,3	8,3	10,35	12,35	16,5	20,55	25,5					
22																
24																
26																
28																
30																
32	4,3	5,35	6,35	8,35	10,4	12,4	16,55	20,55	25,5							
35																
40																
45																
50										6,3	8,4	10,45	12,45	16,6	20,6	25,6
55																
60																
65																
70																
75																
80	8,35	10,4	12,4	16,55	20,6	25,6										
85																
90																
95																
100																
120																
140	10,35	12,35	16,55	20,6	25,6											
160																
180																
200																



**COINDICIONES TÉCNICAS DE SUMINISTRO**

<b>Material</b>	<b>Steel</b>	<b>Austenitic stainless steel</b>
	Hardness 125 HV30 to 245 HV30	A1 in accordance with ISO 3506-1, hardness 210 HV30 to 280 HV30
<b>Grooves</b>	Groove form at the discretion of the supplier.	
<b>Surface finish</b>	Plain, i.e. pins to be supplied in natural finish treated with a protective lubricant, unless otherwise specified by agreement between customer and supplier.	Plain, i.e. pins to be supplied in natural finish
	Preferred coatings are black oxide, phosphate coating or zinc plating with chromate conversion coating (ISO 9717 and 4042). Other coating as agreed between customer and supplier. All tolerance shall apply prior to the application of a plating or coating.	
<b>Workmanship</b>	Pins shall be free of irregularities or detrimental defects.	
<b>Shear strength test</b>	The test shall be in accordance with ISO 8749.	
<b>Acceptability</b>	The acceptance procedure is specified in ISO 3269.	